

**Floor Plan Type 3 Cottage 8, 11, 12**  
SCALE 1:100 @ A1

Granda Consulting Pty Ltd  
 Certificate No: CC441.04/5  
 Approved date: 29 June 2022  
 Verifying Authority: Raeanne Barnes  
 NSW Accreditation No: BDC 2314

NOTE: COTTAGE 8 SHOWN



Architecture | Planning | Interiors

CENTRAL COAST  
 1/28 Adelaide St (PO Box 4400) East Gosford NSW 2250  
 P 0243 21 0503 E admin@ckds.com.au  
 www.ckds.com.au ABN 12 129 231 269

SALTWATER ESTATE

project #  
**18143**

314 Avoca Dr Avoca Beach NSW 2251

Ground Floor (Cottage 8,11,12)

drawing #  
**A-1104** **B**  
 AS SHOWN 25/5/22

This document is the property of CKDS Pty Ltd. It is to be used for the specific project and site only. It is not to be reproduced, stored in a retrieval system, or transmitted in any form or by any means, electronic, mechanical, photocopying, recording, or by any information storage and retrieval system, without the prior written permission of CKDS Pty Ltd.

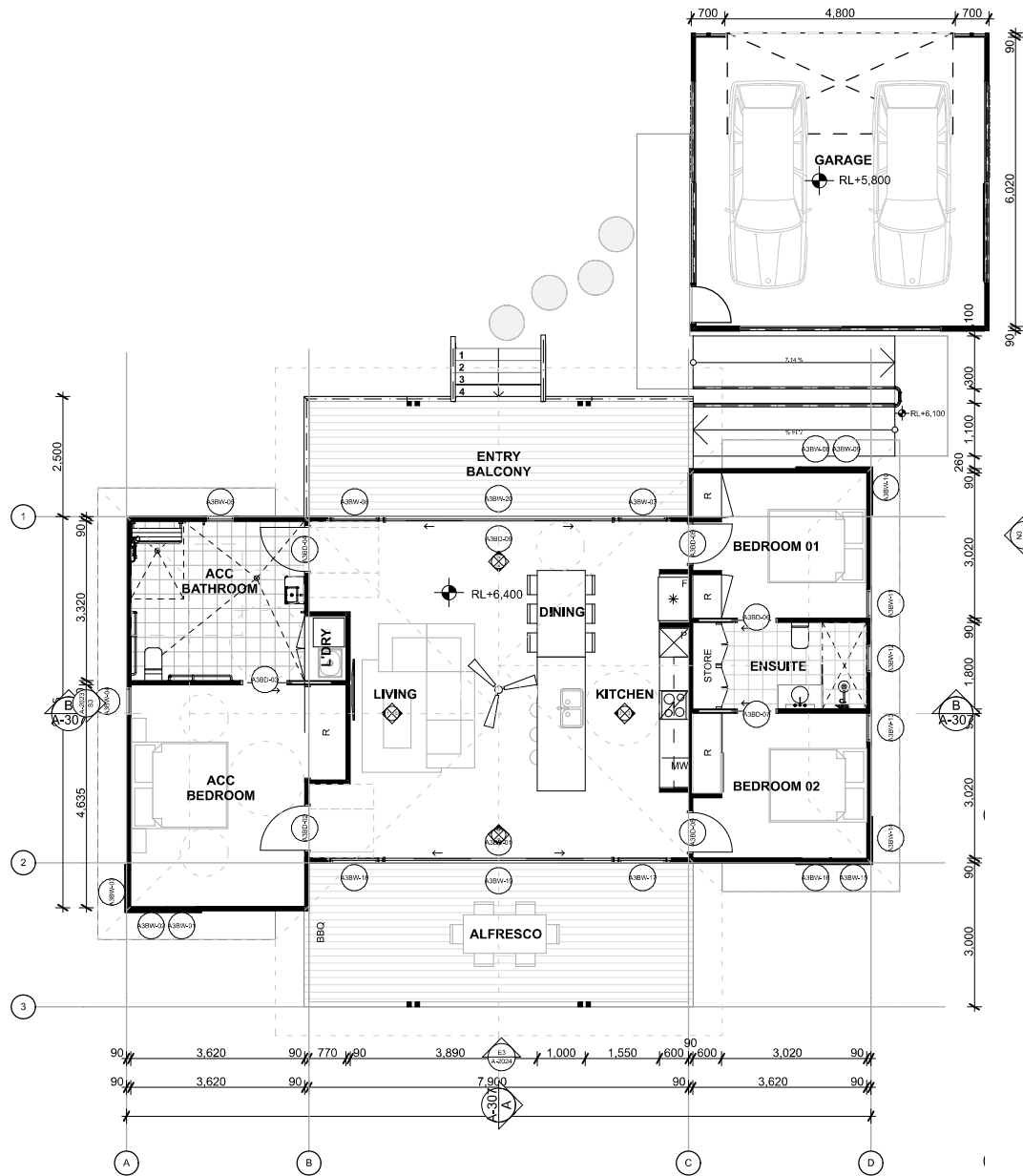

**Floor Plan Type 3B Acc Cottage 9 & 10**  
SCALE 1:100 @ A1

Granda Consulting Pty Ltd	
Cert/Scale No:	Approved date:
CC441.04/5	29 June 2022
Verifying Authority:	Randa Barnes
NSW Accreditation No:	BDC 2314
Under Part 5 of the Environmental Planning and Assessment Act 1979	



**Architecture | Planning | Interiors**  
CENTRAL COAST  
1/28 Adelaide St (PO Box 4400) East Gosford NSW 2250  
P 0243 21 0503 E admin@ckds.com.au  
www.ckds.com.au ABN 12 129 231 269



**SALTWATER ESTATE**  
project #  
**18143**  
314 Avoca Dr Avoca Beach NSW 2251

**Ground Floor Acc (Cottage 9,10)**  
Drawing #  
**A-1105**  
1:100  
Sheet #  
**H**  
25/5/22